

BUSINESS FLATS LTD.

Milestone House | Shallowford Court | Henley-in-Arden | Warwickshire B95 5FY
Tel 01564 795789 | Fax 01564 794437

8348

26th July 2013

8349

Our Ref: DHGS/tns

Warwick District Council
PLANNING DEPT.
Riverside House
Milverton Hill
Leamington Spa
CV32 5HZ

Dear Sirs,

Revised Development Strategy
Section: Kingswood (Lapworth)

We wish to propose the attached development site as suitable for inclusion within the requirements for housing in Kingswood/Lapworth area in accordance with your draft Local Plan.

The site is approximately 1.1 acres of level land, bordered by housing and the canal.

We feel it fits the criteria of requirements within your draft documentation and request that it is put forward for consideration of the Local Plan Housing Allocations in the Autumn.

We support the Council's proposals for completion of up to 150 units in Kingswood/Lapworth area and recognise that these need to be within the Green-Belt land, but our scheme would be an appropriate extension of the village boundary.

Yours faithfully,



Business Flats Ltd

Enc. Plan.

WDC PLANNING
Ref
Office
29 JUL 2013
SCANNED
CC CR PD MA
PRE GEN DIS

Land Registry
Current title plan

Title number **WK467925**
Ordnance Survey map reference **SP1971SW**
Scale **1:1250 enlarged from 1:2500**
Administrative area **Warwickshire : Warwick**

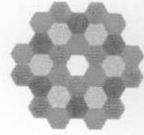

© Crown copyright and database rights 2013 Ordnance Survey 100026316. You are not permitted to copy, sub-license, distribute or sell any of this data to third parties in any form.

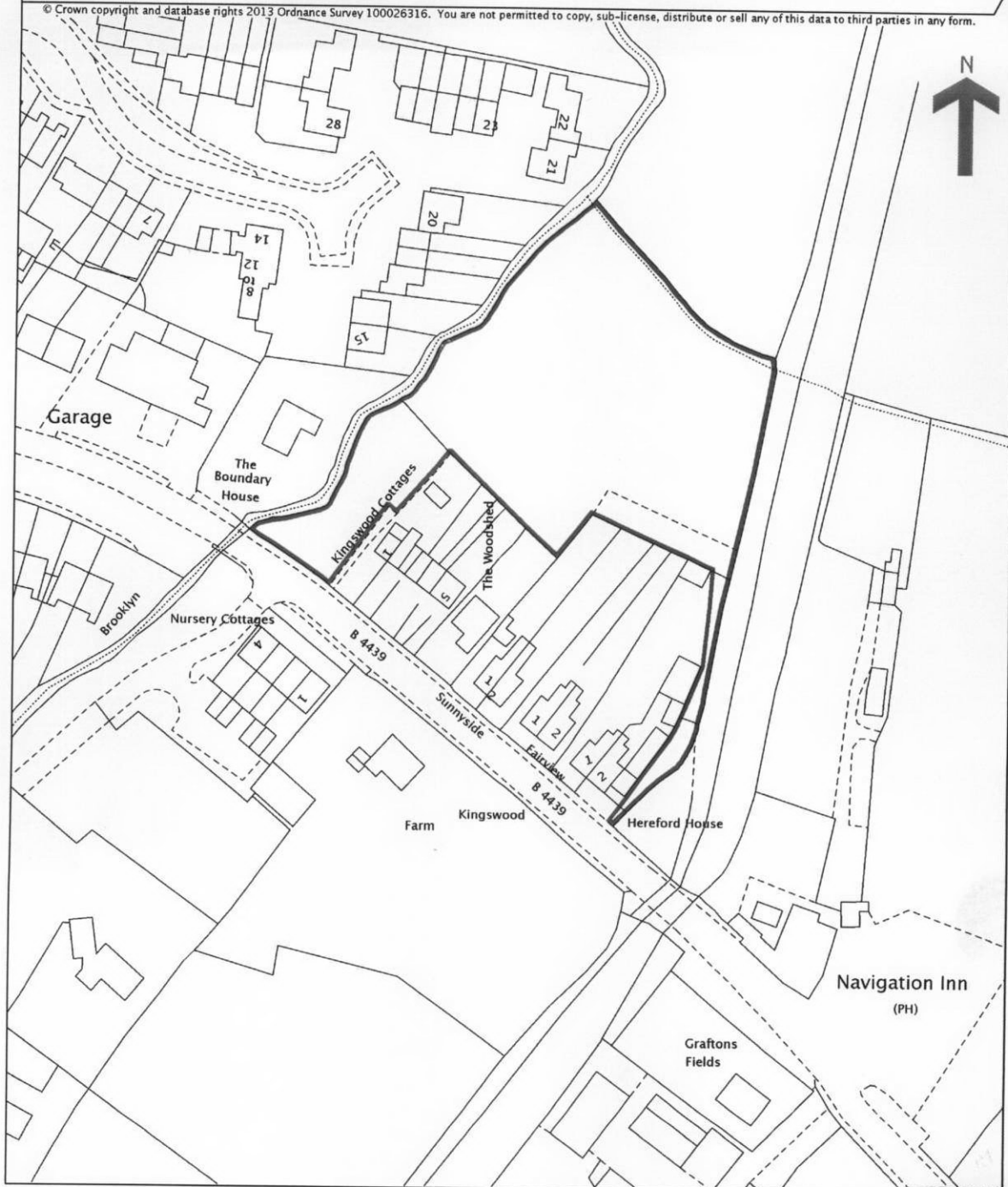

WDC PLANNING

Ref	_____
Offic	_____
29 JUL 2013	
CC	CR PD MA
CON	GEN DIS

This is a copy of the title plan on 25 JUL 2013 at 13:06:20. This copy does not take account of any application made after that time even if still pending in the Land Registry when this copy was issued.

This copy is not an 'Official Copy' of the title plan. An official copy of the title plan is admissible in evidence in a court to the same extent as the original. A person is entitled to be indemnified by the registrar if he suffers loss by reason of a mistake in an official copy. If you want to obtain an official copy, the Land Registry web site explains how to do this.

The Land Registry endeavours to maintain high quality and scale accuracy of title plan images. The quality and accuracy of any print will depend on your printer, your computer and its print settings. This title plan shows the general position, not the exact line, of the boundaries. It may be subject to distortions in scale. Measurements scaled from this plan may not match measurements between the same points on the ground. See Land Registry Public Guide 19 - Title plans and boundaries.

This title is dealt with by Land Registry, Gloucester Office.