

## Preferred Options Response Form

2012

For Official Use Only

Ref:

Rep. Ref.

7399

Please use this form if you wish to support or object to the Preferred Options version of the new Local Plan.

**If you are commenting on multiple sections of the document you will need to complete a separate copy of Part B of this form for each representation.**

This form may be photocopied or, alternatively, extra forms can be obtained from the Council's offices or places where the plan has been made available for members of the public. You can also respond online using the LDF Consultation System, visit: [www.warwickdc.gov.uk/newlocalplan](http://www.warwickdc.gov.uk/newlocalplan)

Ref  
Office  
27 JUN 2012  
SCANNED  
PRE GEN DIS

### Part A - Personal Details

	1. Personal Details	2. Agent's Details (if applicable)
Title	MR.	
First Name	ROGER	
Last Name	WYATT	
Job Title (where relevant)	CHARTERED SURVEYOR	
Organisation (where relevant)	MARGETTS	
Address Line 1	12 HIGH STREET	
Address Line 2	WARWICK	
Address Line 3		
Address Line 4		
Postcode	CV34 4AP	
Telephone number	01926 496262	
Email address	rjwyatt@margetts.co.uk	
Would you like to be made aware of future consultations on the new Local Plan?	<input checked="" type="checkbox"/> Yes	<input type="checkbox"/> No
About You: Gender	M	
Ethnic Origin	Br	
Age		

# Part B - Commenting on the Preferred Options

If you are commenting on multiple sections of the document you will need to complete a separate sheet for each representation

Sheet  of

Which document are you responding to?  
e.g. Preferred Options (Booklet) Preferred Options (Full Version)

PREFERRED OPTIONS SUMMARY

Which part of the document are you responding to?  
Preferred Option Box (e.g. PO1)

PO3

Paragraph number / Heading / Subheading (if relevant)

Map (e.g. Preferred Development Sites - Whole District)

MAP - NORTON LINDSEY

What is the nature of your representation?

Support

Object

Please set out full details of your objection or representation of support. If objecting, please set out what changes could be made to resolve your objection (Use a separate sheet if necessary).

NORTON LINDSEY IS DESIGNATED AS A CATEGORY 2 VILLAGE. IN MY REPRESENTATION OF SUPPORT, I CONFIRM THAT THE VILLAGE SHOULD NOT BE PERMITTED TO STAGNATE, AND THAT SOME LIMITED OPPORTUNITY FOR DEVELOPMENT GROWTH SHOULD BE ALLOWED.

I WILL BE SUBMITTING DEVELOPMENT PROPOSALS FOR TWO SMALL SITES CLOSE TO NORTON LINDSEY VILLAGE CENTRE (SITE PLANS APPENDED)

For Official Use Only

Ref:

Rep. Ref.

6  
5

SHLAA sites  
R25 + R7  
↙ ↘

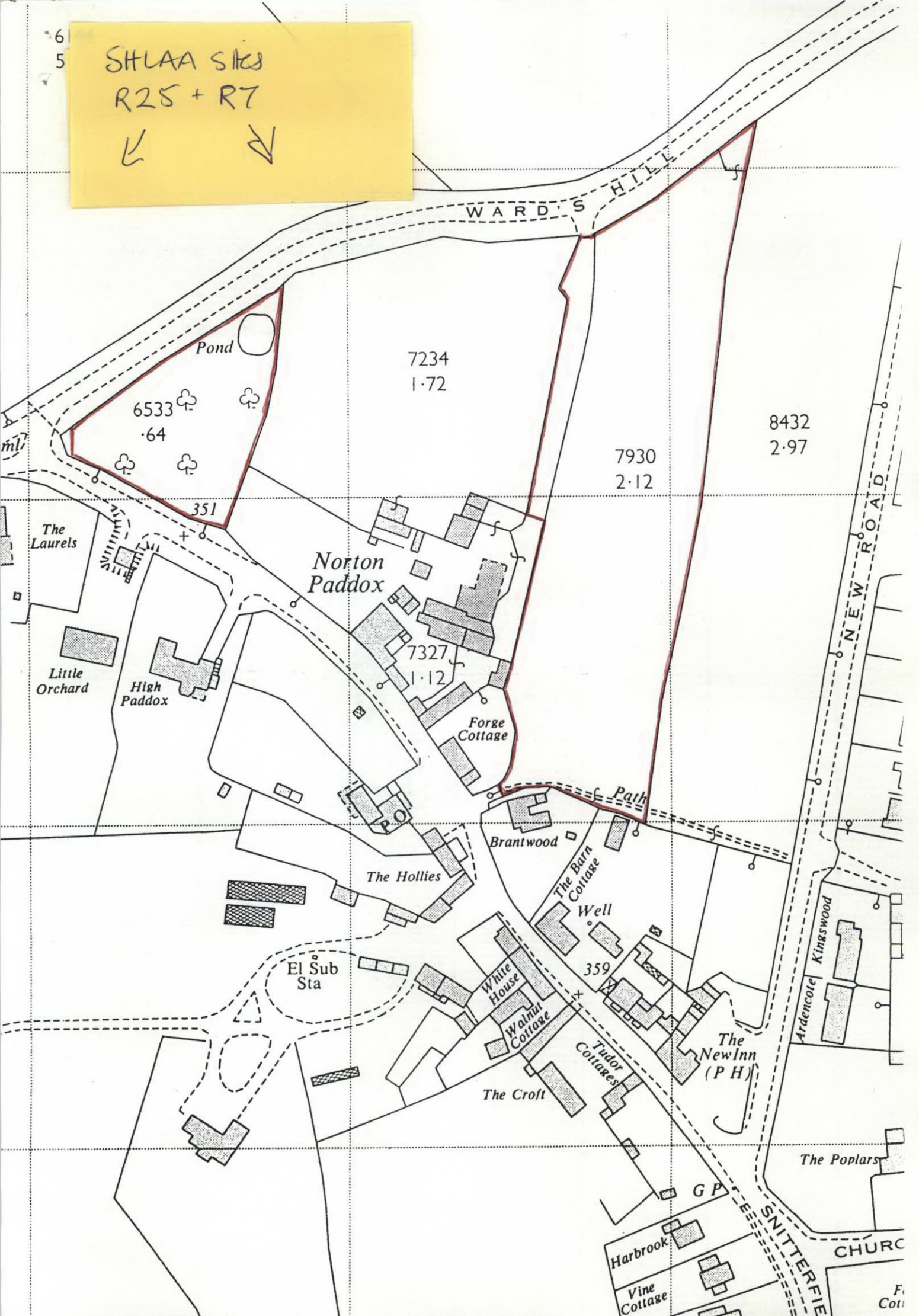

WARD'S HILL

7234  
1.72

8432  
2.97

7930  
2.12

6533  
.64

7327  
1.12

Pond

Norton Paddock

The Laurels

Little Orchard

High Paddock

Forge Cottage

Brantwood

The Hollies

El Sub Sta

White House

Walnut Cottage

The Croft

The Barn Cottage

Well

359

Tidlor Cottages

The New Inn (PH)

Ardencote Kingswood

The Poplars

Harbrook

Vine Cottage

GP

CHURCH

SNITTERFIE